

Basic Tools

LA gINT Tools are built for use with the gINT AGS3 data structure but can be adopted to suit any data structure. They are specifically aimed at the UK market, but many are applicable worldwide. These Tools are in addition to the standard files shipped with all gINT Software products and the free downloads available from gINT Software.

LA gINT Tool	Description	Price
AGS 3.1 Legend Symbols	Over 140 BSI material symbols for common soils (based on 1 major constituent and up to 3 minor constituents) and rocks using the AGS 3.1 numeric naming system.	£50.00
Descriptive Legend Symbols	Over 140 BSI material symbols for common soils (based on 1 major constituent and up to 3 minor constituents) and rocks using the gINT descriptive naming system.	£50.00
Legend Symbols Auto Picker	gINT Rules which automatically pick the legend code based on a strata description.	£ 50.00
Legend Symbols Auto Converter	gINT Rules Add-ins which automatically converts descriptive legend codes (gINT standard) to numeric legend codes (AGS 3.1 standard) and vice versa.	£ 50.00
Coordinate Calculator	gINT Rules add-ins to calculate NAT coordinates and elevation based on LOC coordinates and elevation.	£ 50.00
Railway Symbols	39 material symbols based on RT/CE/C/039 - issue 2 - December 2003 for railways geotechnical sections, associated tile symbols, legend key graphical text report and A4 portrait figure sheet drawing block.	£ 50.00
Drawing Templates	Contains 9 drawing borders formatted to A4, A3 and A1 size, including 2 title block user styles, track codes and figure title block user report variable text links.	£ 35.00

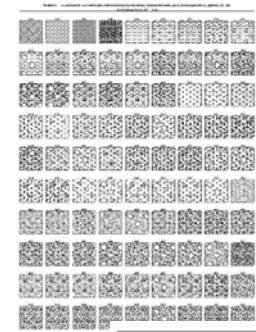

Legend Symbols



Borders

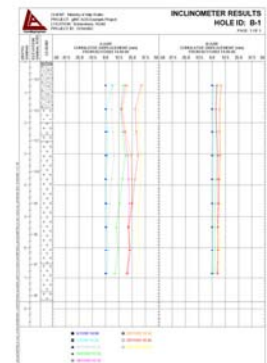

Instrumentation Reports



Sections

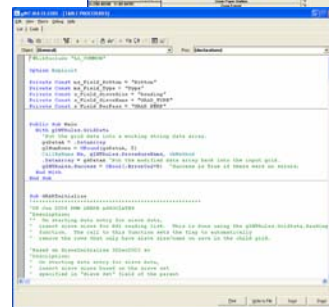

gINT Rules

Contaminated Land Tool

Data management, statistical analysis to CLR7, visualisation and reporting of soil contamination data.

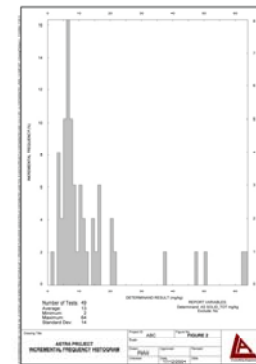
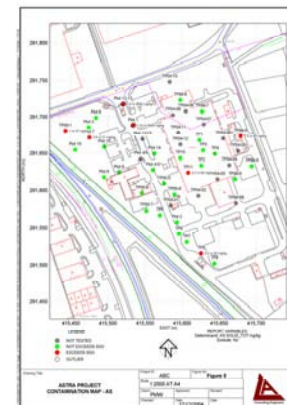
Features	
•	Import AGS, XLS, CSV, TXT, and MDB Data.
•	Import DXF base plan.
•	Database designed around the AGS3 data structure.
•	Entry or import of logging information and geologic interpretation.
•	Statistical populations based on determinand, test type, units, and site sub division.
•	Statistical populations based on sample depth, or depth range such as geology code.
•	User defined land use / target water concentration for each site sub division or one for the entire site/project.
•	User defined determinands, SGV and trigger values, test type, unit and land use / target water concentration combinations.
•	User defined minimum population size to calculate statistics.
•	Exclusion of statistical outliers from statistical populations.
•	User defined upper percentile bound for mean value test.
•	User defined critical percent values for maximum value test.
•	Screening of results and computation of the statistical tests defined in CLR7.
•	No practical limit to the number of samples or test results.
•	Output of colourful and monochrome report quality plans, fences (sections), tables, and histograms that highlight the fails and outliers filtered for user definable determinands, site sub divisions, and determinand groups (i.e. Organics, PAHs...).
•	Export reports as PDF, BMP, JPG, DXF, GDW...
•	Filter reports for outliers, sample depth, and depth range such as geology code.
•	Use of your existing logs and other gINT reports with the tool.
•	Export data using Queries to Excel for further analysis.
•	Export of contouring data.
•	Connect to GIS Software.
•	Free technical support covering installation, licensing issues and any other support needed to keep your Tool running.
•	Comprehensive PDF manual.

Ask for a free online demo and 30 day trial!!

Price : £695

Postage and Packaging (within UK or Ireland) : £10

Licenses are per seat.

All prices exclude VAT.